

包装示意图(端子V型口向外顺时针绕盘)

■ Main Specifications

- 额定电流 (Current rating): 3.0A AC, DC
- 额定电压 (Voltage rating): 250V AC, DC
- 温度范围 (Temperature range): -25°C T0 + 105°C
- 接触电阻 (Contact resistance): ≤20MΩ
- 绝缘电阻 (Insulation resistance): ≥1000MΩ
- 耐电压 (Withstand voltage): 800V AC/minute

规格表	Part No	Wire Range	Insulation O.D	Material	Finish	Qty/reel	Features(Used in)	Remark
	A2002TF-PTS	AWG#30~#24	1.70(MAX)	Phosphor Bronze	Tin-plated	15,000	GJ-A2002 SOCKET HOUSIN SERIES	
	A2004TF-PTS	AWG#30~#24	1.70(MAX)	Phosphor Bronze	Tin-plated	15,000	GJ-A2004 SOCKET HOUSIN SERIES	

GTER ® 东莞市高嘉精密电子有限公司 DONGGUAN GJ PRECISION ELECTRONICS Co.Ltd. PART NO: GJ-A2002TF-PTS 2.00mm WIRE TO BOARD CONNECTOR, SOCKET TERMINAL	APPROVED BY: APPROVED	PROJ:	TOLERANCE	LTR	REVISION RECORD		NAME	DATE
	CHECKED BY: CHECKED	UNIT: mm	-1 ±0.10	标记1	修改内容1	姓名1	日期1	
	DRAWN BY: yiliangdong	SCALE: --	1-5 ±0.15	标记2	修改内容2	姓名2	日期2	
	DATE: 2021-12-30	SHEET: 1/1 A4	5-15 ±0.20	标记3	修改内容3	姓名3	日期3	
	DATE: 2021-12-30	SHEET: 1/1 A4	15-30 ±0.25	标记4	修改内容4	姓名4	日期4	
	DATE: 2021-12-30	SHEET: 1/1 A4	30- ±0.30	CUSTOMER: ---		Conforms to The RoHS&REACH Instruction		
	DATE: 2021-12-30	SHEET: 1/1 A4	(ANGLE) .X ±10°					

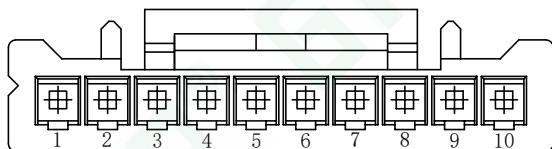
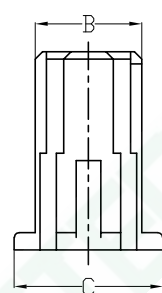
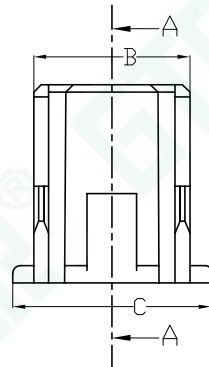
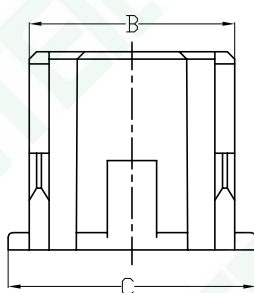
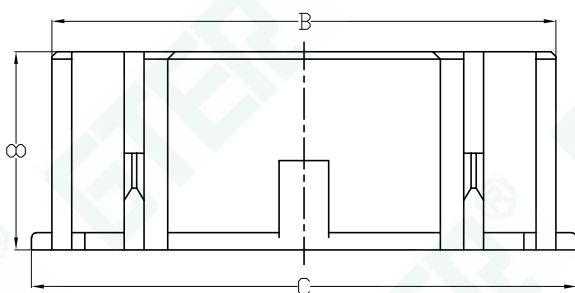
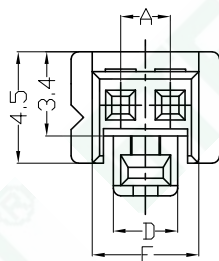
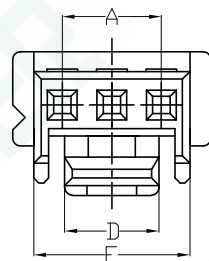
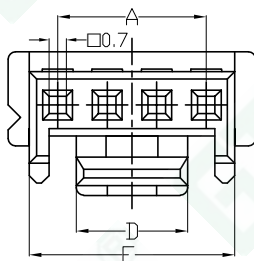
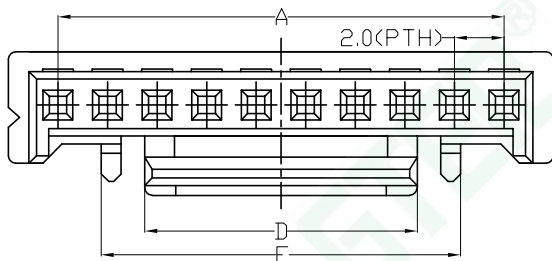

05P-15P

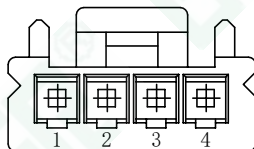

04P

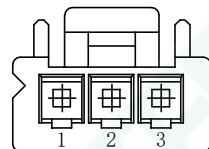

03P

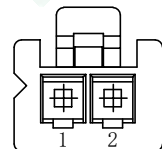

02P

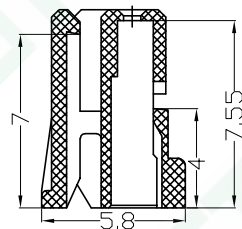

SECTION A-A

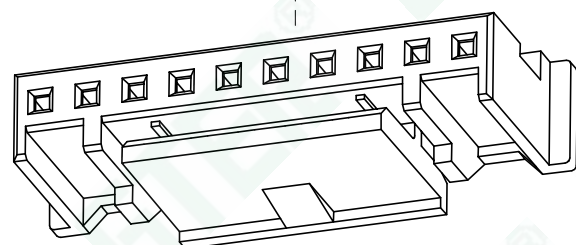

■ Main Specifications

- 接触电阻 (Contact resistance): $\leq 20m\Omega$
- 绝缘电阻 (Insulation resistance): $\geq 1000M\Omega$
- 额定电压 (Rated voltage): 250V AC DC
- 额定电流 (Rated current): 3.0A AC DC
- 耐电压 (Withstand Voltage): 800V AC/minute
- 温度范围 (Temperature Range): $-25^{\circ}C \sim +85^{\circ}C$

■ 产品编码简介: GJ-A2004HF-**-AON

- ① ② ③ ④

1. 系列号;
2. 母胶壳;
3. Pin位数;
4. Nylon66 UL94V-0 (本色)

■ 适配 GJ-A2002 SOCKET TERMINAL.

■ 适配 GJ-A2004 WAFER SERIES.

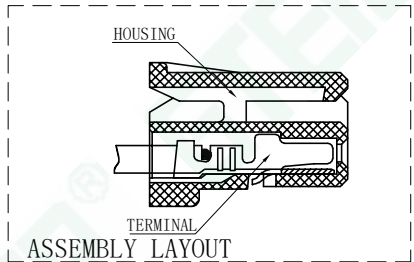

Poles	Dimensions(mm)					Q'ty/ bag
	A	B	C	D	E	
02P	2.00	4.30	6.00	2.60	4.30	1,000
03P	4.00	6.30	8.00	3.80	6.30	1,000
04P	6.00	8.30	10.00	4.50	8.30	1,000
05P	8.00	10.30	12.00	4.50	7.90	1,000
06P	10.00	12.30	14.00	4.50	7.90	1,000
07P	12.00	14.30	16.00	4.50	7.90	1,000
08P	14.00	16.30	18.00	4.50	7.90	1,000
09P	16.00	18.30	20.00	4.50	7.90	1,000
10P	18.00	20.30	22.00	11.00	14.50	1,000
11P	20.00	22.30	24.00	11.00	14.50	1,000
12P	22.00	24.30	26.00	11.00	14.50	1,000
13P	24.00	26.30	28.00	11.00	14.50	1,000
14P	26.00	28.30	30.00	11.00	14.50	1,000
15P	28.00	30.30	32.00	11.00	14.50	1,000

GTER® 东莞市高嘉精密电子有限公司
DONGGUAN GJ PRECISION ELECTRONICS Co.Ltd.

PART NO: GJ-A2004HF-**-AON

2.00mm WIRE TO BOARD CONNECTOR, SOCKET HOUSING

APPROVED BY: APPROVED

CHECKED BY: CHECKED

DRAWN BY: yiliangdong

DATE: 2022-11-30

A2004胶壳 产品图

PROJ:

UNIT: mm

SCALE: --

SHEET: 1/1 A4

VER NO: A0

TOLERANCE

-1 ±0.10

1-5 ±0.15

5-15 ±0.20

15-30 ±0.25

30- ±0.30

(ANGLE) .X ±10°

LTR

标记1 修改内容1

标记2 修改内容2

标记3 修改内容3

标记4 修改内容4

CUSTOMER: ---

REVISION RECORD

NAME

DATE

姓名1

日期1

姓名2

日期2

姓名3

日期3

姓名4

日期4

Conforms to The RoHS&REACH Instruction

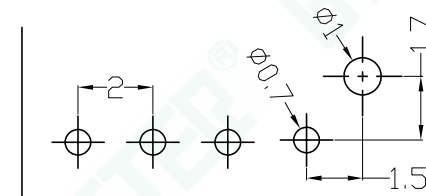
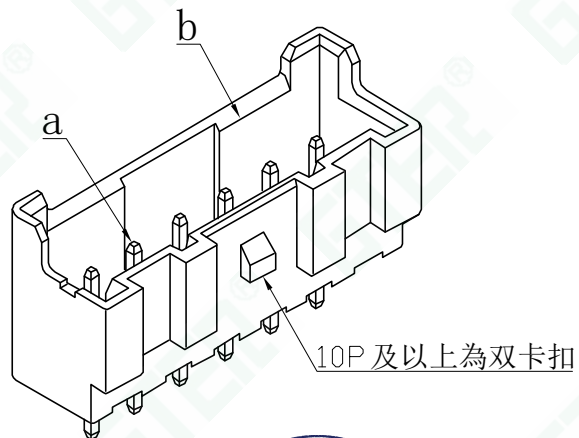
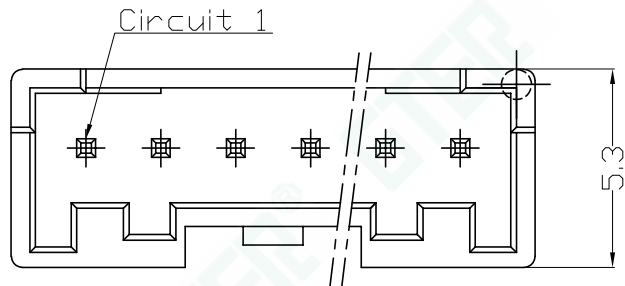

DIP TOP ENTRY TYPE PCB LAYOUT

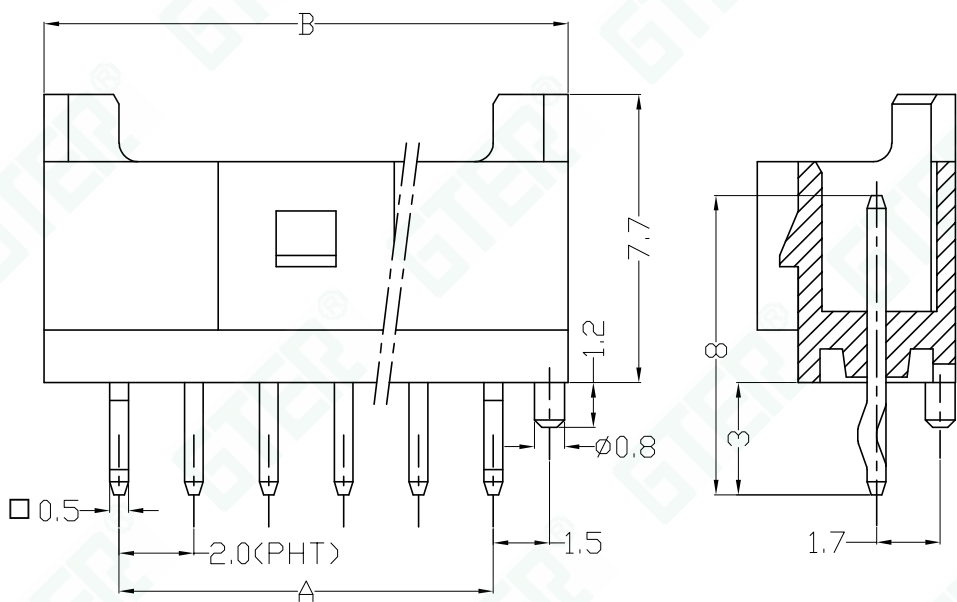

■ Main Specifications

- 接触电阻 (Contact resistance): $\leq 20m\Omega$
- 绝缘电阻 (Insulation resistance): $\geq 1000M\Omega$
- 额定电压 (Rated voltage): 250V AC DC
- 额定电流 (Rated current): 3.0A AC DC
- 耐电压 (Withstand Voltage): 800V AC/minute
- 温度范围 (Temperature Range): $-25^{\circ}C \sim +85^{\circ}C$
- 线数 (Poles no): 2 to 20 P

■ 产品编码简介: GJ-A2004WVD-**-A0N-P
① ② ③ ④ ⑤

1. 系列号;
2. 立式插板针座;
3. Pin位数;
4. Nylon66 UL94V-0 (本色)
5. P-带定位柱

■ 适配 GJ-A2004 SOCKET HOUSING SERIES.

■ 适用基板厚度 1.2MM-1.6MM.

Poles	Dimensions(mm)		Q'ty/ bag
	A	B	
02P	2.00	6.00	1,000
03P	4.00	8.00	1,000
04P	6.00	10.00	1,000
05P	8.00	12.00	1,000
06P	10.00	14.00	1,000
07P	12.00	16.00	1,000
08P	14.00	18.00	1,000
09P	16.00	20.00	1,000
10P	18.00	22.00	1,000
11P	20.00	24.00	1,000
12P	22.00	26.00	1,000
13P	24.00	28.00	1,000
14P	26.00	30.00	1,000
15P	28.00	32.00	1,000

组成序号	名称	材质
a	0.5方pin针	青铜镀亮锡
b	胶壳本体	Nylon66 UL94V-0(本色)

GTER® 东莞市高嘉精密电子有限公司
DONGGUAN GJ PRECISION ELECTRONICS Co.Ltd.

PART NO: GJ-A2004WVD-**-A0N

2.00mm WIRE TO BOARD CONNECTOR, WAFER (V-DIP TYPE)

APPROVED BY: APPROVED	PROJ:	TOLERANCE	LTR	REVISION RECORD	NAME	DATE
CHECKED BY: CHECKED	UNIT: mm	-1 ±0.10	标记1	修改内容1	姓名1	日期1
DRAWN BY: yiliangdong	SCALE: --	1-5 ±0.15	标记2	修改内容2	姓名2	日期2
DATE: 2023-10-18	SHEET: 1/1 A4	5-15 ±0.20	标记3	修改内容3	姓名3	日期3
A2004立式插板针座产品图	VER NO: AO	15-30 ±0.25	标记4	修改内容4	姓名4	日期4
		30- ±0.30	CUSTOMER: ---		Conforms to The RoHS&REACH Instruction	
		(ANGLE) .X ±10°				

A

B

C

D

E

F

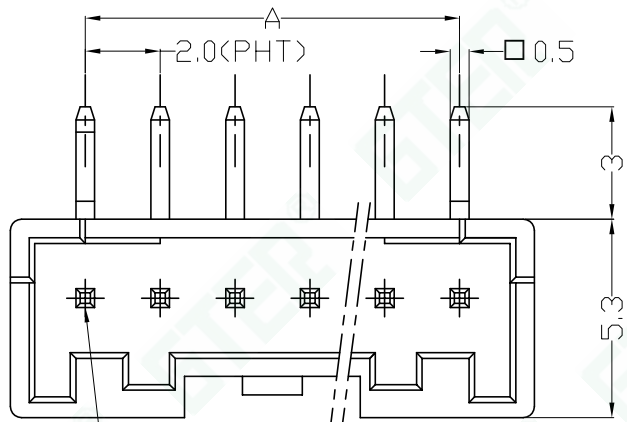

Circuit 1

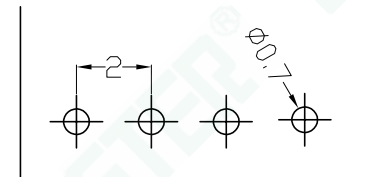
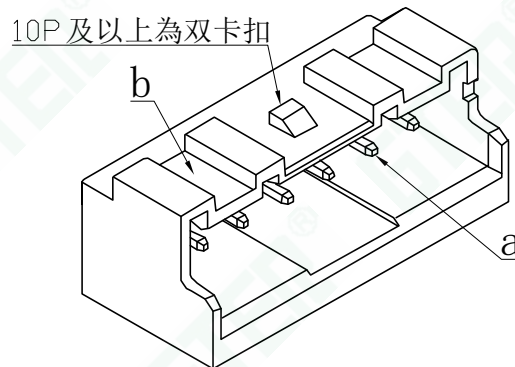
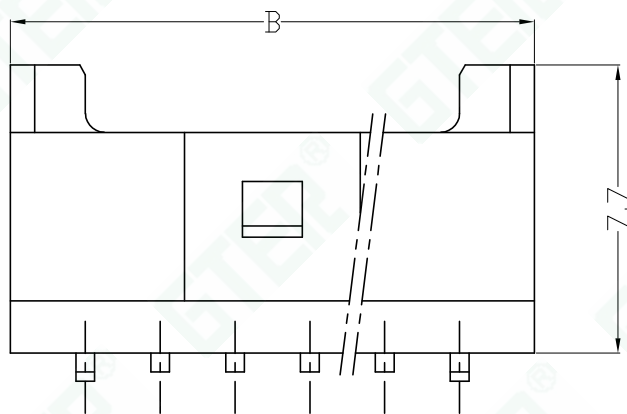

DIP SIDE ENTRY TYPE PCB LAYOUT

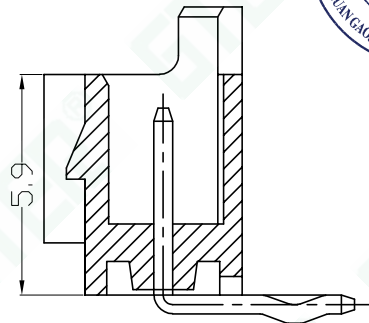

■ Main Specifications

- 接触电阻 (Contact resistance): $\leq 20m\Omega$
- 绝缘电阻 (Insulation resistance): $\geq 1000M\Omega$
- 额定电压 (Rated voltage): 250V AC DC
- 额定电流 (Rated current): 3.0A AC DC
- 耐电压 (Withstand Voltage): 800V AC/minute
- 温度范围 (Temperature Range): $-25^{\circ}C \sim +85^{\circ}C$
- 线数 (Poles no): 4 to 40 P

■ 产品编码简介: GJ-A2004WRD-**-AON

1. 系列号; ① ② ③ ④
2. 卧式插板针座;
3. Pin位数;
4. Nylon66 UL94V-0 (本色)

■ 适配 GJ-A2004 SOCKET HOUSING SERIES.

■ 适用基板厚度 1.2MM-1.6MM.

Poles	Dimensions(mm)		Q'ty/ bag
	A	B	
02P	2.00	6.00	1,000
03P	4.00	8.00	1,000
04P	6.00	10.00	1,000
05P	8.00	12.00	1,000
06P	10.00	14.00	1,000
07P	12.00	16.00	1,000
08P	14.00	18.00	1,000
09P	16.00	20.00	1,000
10P	18.00	22.00	1,000
11P	20.00	24.00	1,000
12P	22.00	26.00	1,000
13P	24.00	28.00	1,000
14P	26.00	30.00	1,000
15P	28.00	32.00	1,000

组成序号	名称	材质
a	0.5方pin针	青铜镀亮锡
b	胶壳本体	Nylon66 UL94V-0(本色)

GTER® 东莞市高嘉精密电子有限公司
DONGGUAN GJ PRECISION ELECTRONICS Co.Ltd.

PART NO: GJ-A2004WRD-**-AON

2.00mm WIRE TO BOARD CONNECTOR, WAFER (R-DIP TYPE)

APPROVED BY: APPROVED	PROJ:	TOLERANCE	LTR	REVISION RECORD		NAME	DATE
CHECKED BY: CHECKED	UNIT: mm	-1 ±0.10	标记1	修改内容1	姓名1	日期1	
DRAWN BY: yiliangdong	SCALE: --	1-5 ±0.15	标记2	修改内容2	姓名2	日期2	
DATE: 2023-10-18	SHEET: 1/1 A4	5-15 ±0.20	标记3	修改内容3	姓名3	日期3	
A2004卧式插板针座产品图	VER NO: AO	15-30 ±0.25	标记4	修改内容4	姓名4	日期4	
		30- ±0.30	CUSTOMER: ---		Conforms to The RoHS&REACH Instruction		
		(ANGLE) .X ±10°					

A

B

C

D

E

F