

包装示意图(端子V型口向外顺时针绕盘)

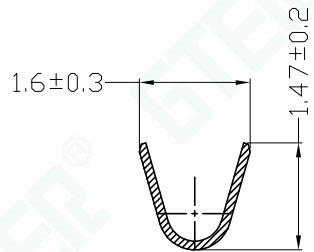

SECTION A-A

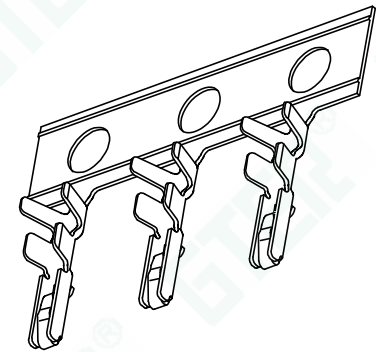
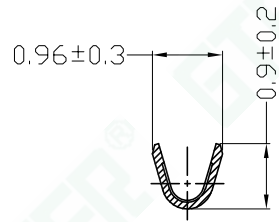

SECTION B-B

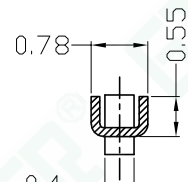

SECTION C-C

■ Main Specifications

- 额定电流 (Current rating): 1.0A AC, DC
- 额定电压 (Voltage rating): 50V AC, DC
- 温度范围 (Temperature range): -25°C TO + 105°C
- 接触电阻 (Contact resistance): ≤20MΩ
- 绝缘电阻 (Insulation resistance): ≥100MΩ
- 耐电压 (Withstand voltage): 500V AC/minute

规格表	Part No	Wire Range	Insulation O.D	Material	Finish	Qty/reel	Features (Used in)	Remark
	A1002TM-PTS	AWG#32~#28	0.80 (MAX)	Phosphor Bronze	Tin-plated	25,000	GJ-A1002 SOCKET HOUSIN SERIES	JST-NSH1.0
	A1004TM-PTS						GJ-A1004 SOCKET HOUSIN SERIES	JST-SHLD1.0

GTER® 东莞市高嘉精密电子有限公司
DONGGUAN GJ PRECISION ELECTRONICS Co.,Ltd.

PART NO: GJ-A1002TM-PTS

1.00mm WIRE TO BOARD CONNECTOR, PLUG TERMINAL

APPROVED BY: APPROVED

CHECKED BY: CHECKED

DRAWN BY: yiliangdong

DATE: 2024-04-22

A1002端子 产品图

PROJ:

UNIT: mm

SCALE: --

SHEET: 1/1 | A4

VER NO: AO

TOLERANCE

-1 ±0.10

1-5 ±0.15

5-15 ±0.20

15-30 ±0.25

30- ±0.30

(ANGLE) X ±10°

LTR

标记1

标记2

标记3

标记4

CUSTOMER: ---

REVISION RECORD

修改内容1

修改内容2

修改内容3

修改内容4

NAME

姓名1

姓名2

姓名3

姓名4

DATE

日期1

日期2

日期3

日期4

Conforms to The RoHS&REACH Instruction

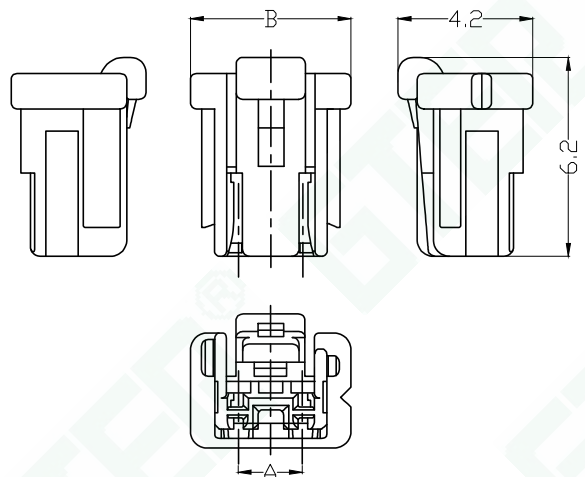

2 Circuit

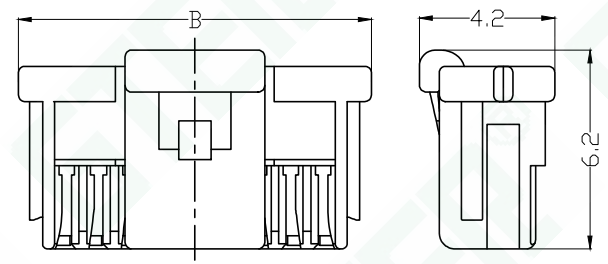

4-9 Circuit

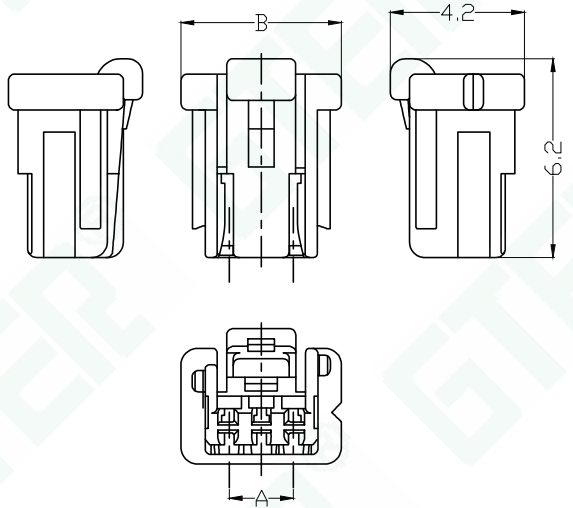

3 Circuit

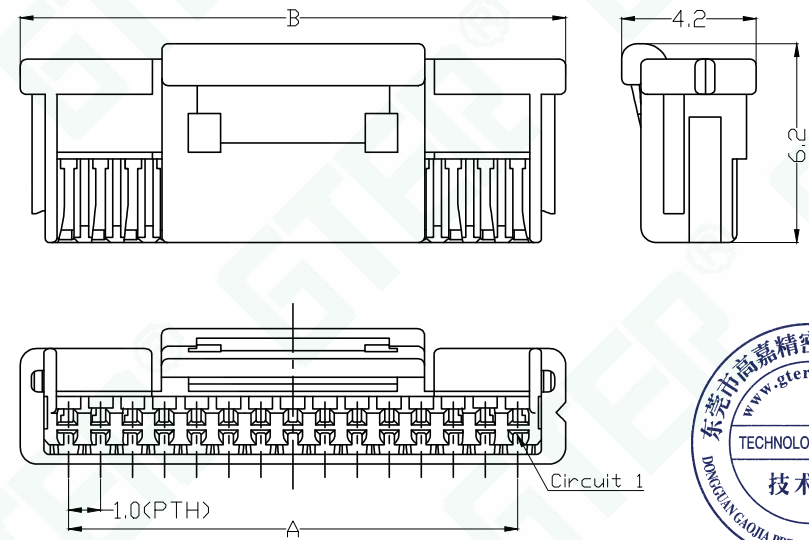

10-15 Circuit

■ Main Specifications

- 接触电阻 (Contact resistance): $\leq 20m\Omega$
- 绝缘电阻 (Insulation resistance): $\geq 100M\Omega$
- 额定电压 (Rated voltage): 50V AC DC
- 额定电流 (Rated current): 1.0A AC DC
- 耐电压 (Withstand Voltage): 500V AC/minute
- 温度范围 (Temperature Range): $-25^{\circ}C \sim +85^{\circ}C$

■ 产品编码简: GJ-A1002HM-**-AON

① ② ③ ④

1. 系列号;
2. 公胶壳;
3. Pin位数;
4. Nylon66 UL94V-0 (本色)

■ 包装 PE袋包装, 每袋1,000PCS.

■ 适配 GJ-W1002 WAFER SERIES.

■ 适配 GJ-A1002 PLUG TERMINAL.

Poles	Dimensions(mm)		Q'ty/ bag
	A	B	
2P	2.0	5.00	1,000
3P	2.0	5.00	1,000
4P	3.0	6.00	1,000
5P	4.0	7.00	1,000
6P	5.0	8.00	1,000
7P	6.0	9.00	1,000
8P	7.0	10.00	1,000
9P	8.0	11.00	1,000
10P	9.0	12.00	1,000
11P	10.0	13.00	1,000
12P	11.0	14.00	1,000
13P	12.0	15.00	1,000
14P	13.0	16.00	1,000
15P	14.0	17.00	1,000



GTER® 东莞市高嘉精密电子有限公司
DONGGUAN GJ PRECISION ELECTRONICS Co.Ltd.

PART NO: GJ-A1002HM-**-AON

1.00mm WIRE TO BOARD CONNECTOR, PLUG HOUSING

APPROVED BY: APPROVED
CHECKED BY: CHECKED
DRAWN BY: yiliangdong
DATE: 2021-11-25
A1002胶壳 产品图

PROJ: 
UNIT: mm
SCALE: --
SHEET: 1/1 A4
VER NO: AO

TOLERANCE
-1 ±0.10
1-5 ±0.15
5-15 ±0.20
15-30 ±0.25
30- ±0.30
(ANGLE) .X ±10°

LTR
标记1 修改内容1
标记2 修改内容2
标记3 修改内容3
标记4 修改内容4
CUSTOMER: ---

REVISION RECORD
NAME DATE
姓名1 日期1
姓名2 日期2
姓名3 日期3
姓名4 日期4
Conforms to The RoHS&REACH Instruction

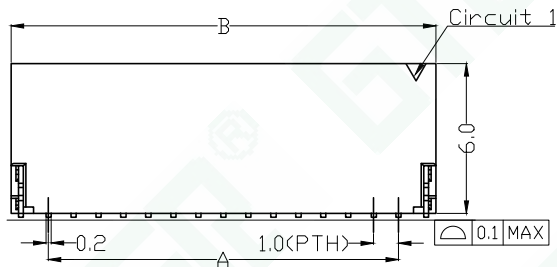
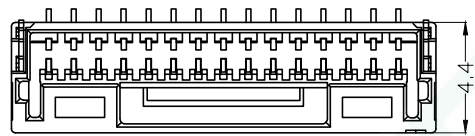

10to15 Circuit

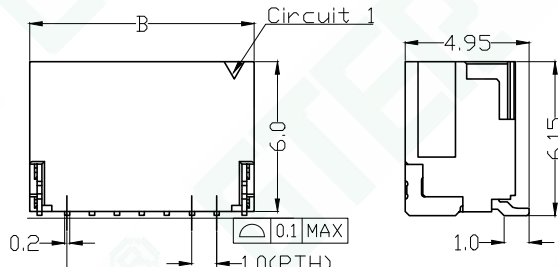
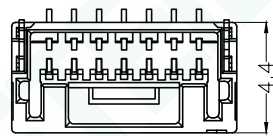

4to9 Circuit

■ Main Specifications

- 接触电阻 (Contact resistance): $\leq 20m\Omega$
- 绝缘电阻 (Insulation resistance): $\geq 100M\Omega$
- 额定电压 (Rated voltage): 50V AC DC
- 额定电流 (Rated current): 1.0A AC DC
- 耐电压 (Withstand Voltage): 500V AC/minute
- 温度范围 (Temperature Range): $-25^{\circ}C \sim +105^{\circ}C$

■ 产品编码简介: GJ-A1002WVS-**-FON

① ② ③ ④

1. 系列号;
2. 立式贴板针座;
3. Pin位数;
4. LCP UL94V-0 (本色)

■ 适配 GJ-A1002 SOCKET HOUSING SERIES.

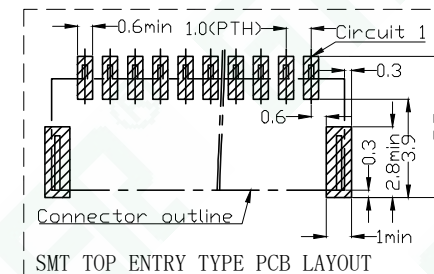

SMT TOP ENTRY TYPE PCB LAYOUT

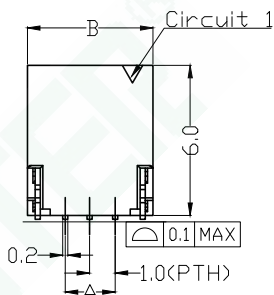
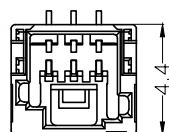

3 Circuit

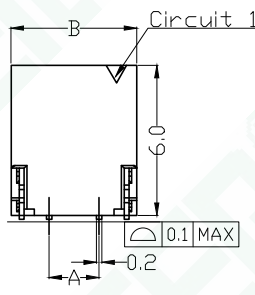
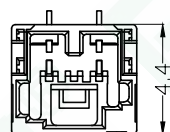

2 Circuit

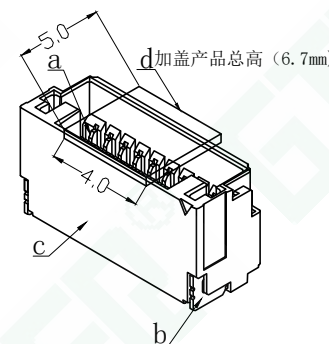

组成序号	名称	材质
a	0.2 pin针	磷铜镀高温亮锡
b	接地片	磷铜镀高温亮锡
c	WAFER 主体	LCP(本色) UL94V-0
d	吸盖	LCP(本色) UL94V-0

Poles	Dimensions (mm)		Q'ty/ reel
	A	B	
2P	2.00	5.00	1,000
3P	2.00	5.00	1,000
4P	3.00	6.00	1,000
5P	4.00	7.00	1,000
6P	5.00	8.00	1,000
7P	6.00	9.00	1,000
8P	7.00	10.00	1,000
9P	8.00	11.00	1,000
10P	9.00	12.00	1,000
11P	10.00	13.00	1,000
12P	11.00	14.00	1,000
13P	12.00	15.00	1,000
14P	13.00	16.00	1,000
15P	14.00	17.00	1,000

GTER® 东莞市高嘉精密电子有限公司
DONGGUAN GJ PRECISION ELECTRONICS Co.Ltd.

PART NO: GJ-A1002WVS-**-FON

1.00mm WIRE TO BOARD CONNECTOR, WAFER (V-SMT TYPE)

APPROVED BY: APPROVED

CHECKED BY: CHECKED

DRAWN BY: yiliangdong

DATE: 2021-11-25

A1002立式贴板针座产品图

PROJ:

UNIT: mm

SCALE: --

SHEET: 1/1 A4

VER NO: AO

TOLERANCE

-1 ±0.10

1-5 ±0.15

5-15 ±0.20

15-30 ±0.25

30- ±0.30

(ANGLE) .X ±10°

LTR

标记1

标记2

标记3

标记4

CUSTOMER: ---

REVISION RECORD

修改内容1

修改内容2

修改内容3

修改内容4

NAME DATE

姓名1 日期1

姓名2 日期2

姓名3 日期3

姓名4 日期4

Conforms to The RoHS&REACH Instruction

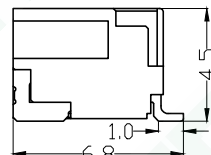
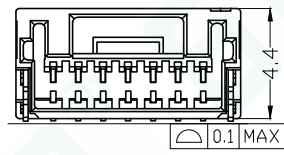
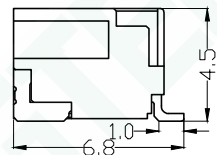
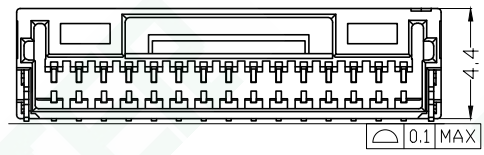
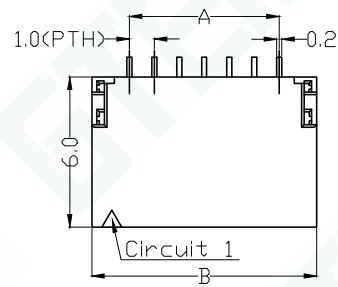
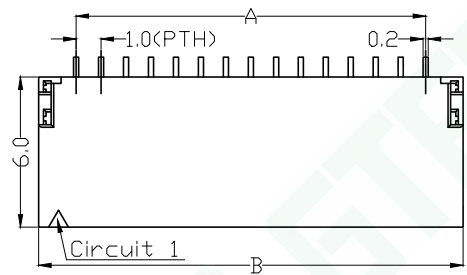

■ Main Specifications

- 接触电阻 (Contact resistance): $\leq 20\text{m}\Omega$
- 绝缘电阻 (Insulation resistance): $\geq 100\text{M}\Omega$
- 额定电压 (Rated voltage): 50V AC DC
- 额定电流 (Rated current): 1.0A AC DC
- 耐电压 (Withstand Voltage): 500V AC/minute
- 温度范围 (Temperature Range): $-25^{\circ}\text{C} \sim +105^{\circ}\text{C}$

■ 产品编码简介: GJ-A1002WRS-**-FON

- ① 系列号;
- ② 卧式贴板针座;
- ③ Pin位数;
- ④ LCP UL94V-0 (本色)

■ 适配 GJ-A1002 SOCKET HOUSING SERIES.

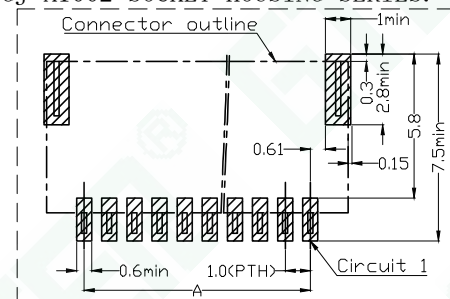

SMT SIDE ENTRY TYPE PCB LAYOUT

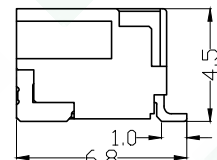
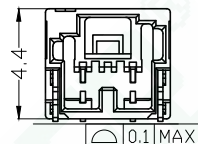
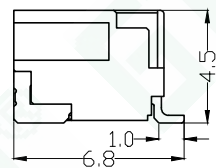
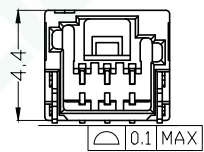
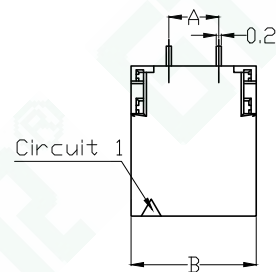
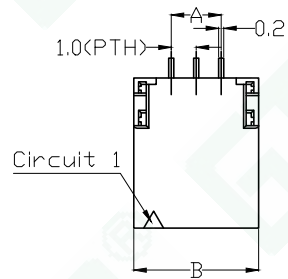
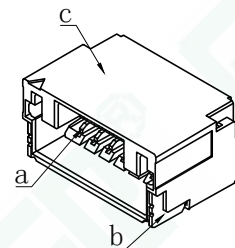

Poles	Dimensions (mm)		Q'ty/ reel
	A	B	
2P	2.00	5.00	1,500
3P	2.00	5.00	1,500
4P	3.00	6.00	1,500
5P	4.00	7.00	1,500
6P	5.00	8.00	1,500
7P	6.00	9.00	1,500
8P	7.00	10.00	1,500
9P	8.00	11.00	1,500
10P	9.00	12.00	1,500
11P	10.00	13.00	1,500
12P	11.00	14.00	1,500
13P	12.00	15.00	1,500
14P	13.00	16.00	1,500
15P	14.00	17.00	1,500

组成序号	名称	材质
a	0.2 pin针	磷铜镀高温亮锡
b	接地片	磷铜镀高温亮锡
c	WAFER 主体	LCP(本色) UL94V-0

GTER® 东莞市高嘉精密电子有限公司
DONGGUAN GJ PRECISION ELECTRONICS Co.Ltd.

PART NO: GJ-A1002WRS-**-FON

1.00mm WIRE TO BOARD CONNECTOR, WAFER (V-SMT TYPE)

APPROVED BY: APPROVED
CHECKED BY: CHECKED
DRAWN BY: yiliangdong
DATE: 2021-11-25
A1002卧式贴板针座产品图

PROJ: 
UNIT: mm
SCALE: --
SHEET: 1/1 A4
VER NO: AO

TOLERANCE
-1 ±0.10
1-5 ±0.15
5-15 ±0.20
15-30 ±0.25
30- ±0.30
(ANGLE) .X ±10°

LTR
标记1 修改内容1
标记2 修改内容2
标记3 修改内容3
标记4 修改内容4
CUSTOMER: ---

REVISION RECORD
NAME DATE
姓名1 日期1
姓名2 日期2
姓名3 日期3
姓名4 日期4
Conforms to The RoHS&REACH Instruction