

包装示意图(端子V型口向外顺时针绕盘)

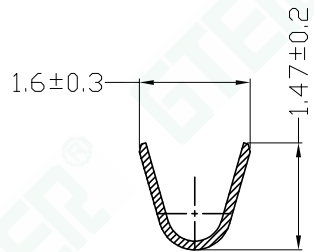

SECTION A-A

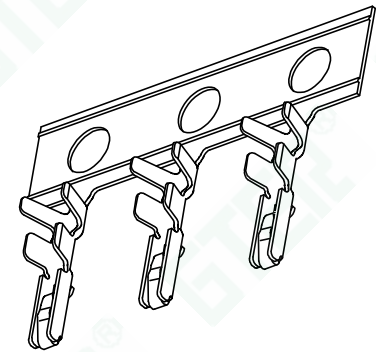
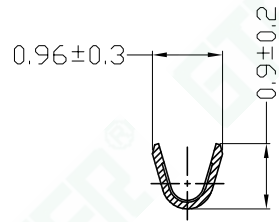

SECTION B-B

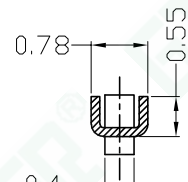

SECTION C-C

■ Main Specifications

- 额定电流 (Current rating): 1.0A AC, DC
- 额定电压 (Voltage rating): 50V AC, DC
- 温度范围 (Temperature range): -25°C TO + 105°C
- 接触电阻 (Contact resistance): ≤20MΩ
- 绝缘电阻 (Insulation resistance): ≥100MΩ
- 耐电压 (Withstand voltage): 500V AC/minute

规格表	Part No	Wire Range	Insulation O.D	Material	Finish	Qty/reel	Features (Used in)	Remark
	A1002TM-PTS	AWG#32~#28	0.80 (MAX)	Phosphor Bronze	Tin-plated	25,000	GJ-A1002 SOCKET HOUSIN SERIES	JST-NSH1.0
	A1004TM-PTS						GJ-A1004 SOCKET HOUSIN SERIES	JST-SHLD1.0

GTER® 东莞市高嘉精密电子有限公司
DONGGUAN GJ PRECISION ELECTRONICS Co.,Ltd.

APPROVED BY: APPROVED

CHECKED BY: CHECKED

DRAWN BY: yiliangdong

DATE: 2024-04-22

A1002端子 产品图

PROJ:

UNIT: mm

SCALE: --

SHEET: 1/1 A4

VER NO: AO

TOLERANCE

-1 ±0.10

1-5 ±0.15

5-15 ±0.20

15-30 ±0.25

30- ±0.30

(ANGLE) X ±10°

LTR

标记1

标记2

标记3

标记4

CUSTOMER: ---

REVISION RECORD

修改内容1

修改内容2

修改内容3

修改内容4

NAME

姓名1

姓名2

姓名3

姓名4

DATE

日期1

日期2

日期3

日期4

PART NO: GJ-A1002TM-PTS

1.00mm WIRE TO BOARD CONNECTOR, PLUG TERMINAL

CUSTOMER: ---

Conforms to The RoHS&REACH Instruction

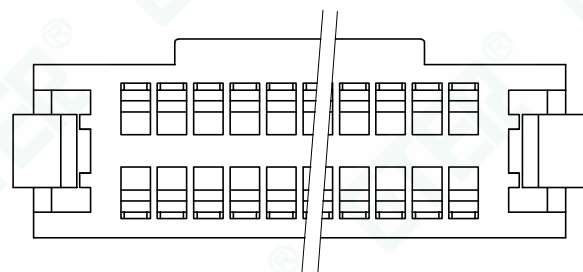
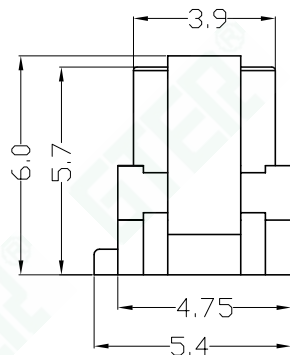
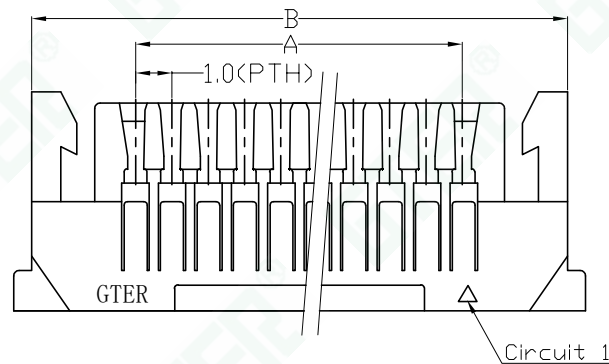
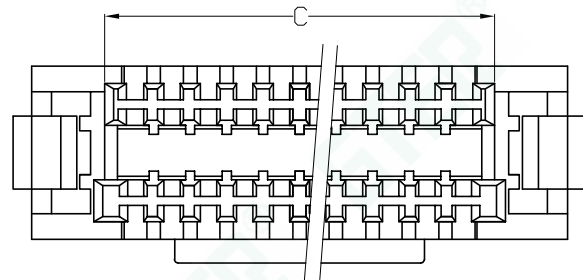

■ Main Specifications

- 接触电阻 (Contact resistance): $\leq 20m\Omega$
- 绝缘电阻 (Insulation resistance): $\geq 100M\Omega$
- 额定电压 (Rated voltage): 50V AC DC
- 额定电流 (Rated current): 1.0A AC DC
- 耐电压 (Withstand Voltage): 500V AC/minute
- 温度范围 (Temperature Range): $-25^{\circ}C \sim +85^{\circ}C$



Poles	Dimensions(mm)			Q'ty/ bag
	A	B	C	
2X2P	1.0	6.70	2.70	1,000
2X3P	2.0	7.70	3.70	1,000
2X4P	3.0	8.70	4.70	1,000
2X5P	4.0	9.70	5.70	1,000
2X6P	5.0	10.70	6.70	1,000
2X7P	6.0	11.70	7.70	1,000
2X8P	7.0	12.70	8.70	1,000
2X9P	8.0	13.70	9.70	1,000
2X10P	9.0	14.70	10.70	1,000
2X11P	10.0	15.70	11.70	1,000
2X12P	11.0	16.70	12.70	1,000
2X13P	12.0	17.70	13.70	1,000
2X14P	13.0	18.70	14.70	1,000
2X15P	14.0	19.70	15.70	1,000
—	—	—	—	—
2X20P	19.0	24.70	20.70	1,000
—	—	—	—	—
2X25P	24.0	29.70	25.70	1,000
—	—	—	—	—
2X30P	29.0	34.70	30.70	1,000

■ 产品编码简: GJ-A1004HM-**-AON

1. 系列号; ① ② ③ ④
2. 公胶壳;
3. Pin位数;
4. Nylon66 UL94V-0 (本色)

■ 包装 PE袋包装, 每袋1,000PCS.

■ 适配 GJ-A1004 WAFER SERIES.

■ 适配 GJ-A1002 PLUG TERMINAL.

GTER® 东莞市高嘉精密电子有限公司
DONGGUAN GJ PRECISION ELECTRONICS Co.Ltd.

PART NO: GJ-A1004HM-**-AON

1.00mm WIRE TO BOARD CONNECTOR, PLUG HOUSING

APPROVED BY: APPROVED

CHECKED BY: CHECKED

DRAWN BY: yiliangdong

DATE: 2022-09-03

A1004胶壳 产品图

PROJ:

UNIT: mm

SCALE: --

SHEET: 1/1 A4

VER NO: A0

TOLERANCE

-1 ±0.10

1-5 ±0.15

5-15 ±0.20

15-30 ±0.25

30- ±0.30

(ANGLE) X ±10°

LTR

标记1

标记2

标记3

标记4

CUSTOMER: ---

REVISION RECORD

修改内容1

修改内容2

修改内容3

修改内容4

NAME

姓名1

姓名2

姓名3

姓名4

DATE

日期1

日期2

日期3

日期4

Conforms to The RoHS&REACH Instruction

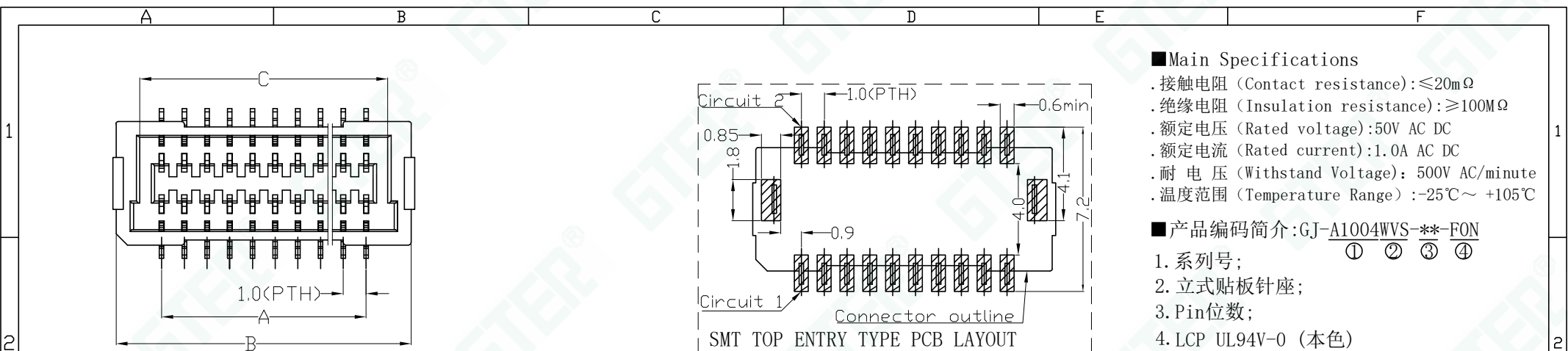

- Main Specifications
- . 接触电阻 (Contact resistance): $\leq 20m\Omega$
 - . 绝缘电阻 (Insulation resistance): $\geq 100M\Omega$
 - . 额定电压 (Rated voltage): 50V AC DC
 - . 额定电流 (Rated current): 1.0A AC DC
 - . 耐电压 (Withstand Voltage): 500V AC/minute
 - . 温度范围 (Temperature Range) : $-25^{\circ}C \sim +105^{\circ}C$

- 产品编码简介: GJ-A1004WVS-**-FON
- ① ② ③ ④
1. 系列号;
 2. 立式贴板针座;
 3. Pin位数;
 4. LCP UL94V-0 (本色)
- 适配 GJ-A1004 SOCKET HOUSING SERIES.

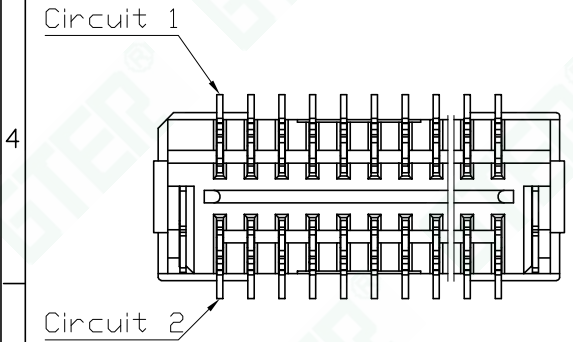
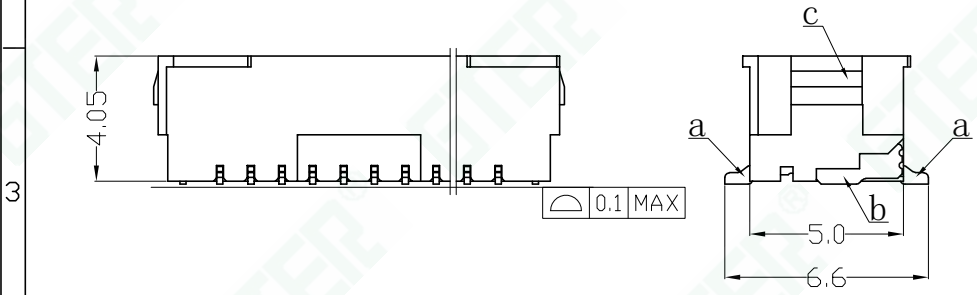

Poles	Dimensions(mm)			Q'ty/ bag
	A	B	C	
2X2P	1.0	5.00	2.90	1,000
2X3P	2.0	6.00	3.90	1,000
2X4P	3.0	7.00	4.90	1,000
2X5P	4.0	8.00	5.90	1,000
2X6P	5.0	9.00	6.90	1,000
2X7P	6.0	10.00	7.90	1,000
2X8P	7.0	11.00	8.90	1,000
2X9P	8.0	12.00	9.90	1,000
2X10P	9.0	13.00	10.90	1,000
2X11P	10.0	14.00	11.90	1,000
2X12P	11.0	15.00	12.90	1,000
2X13P	12.0	16.00	13.90	1,000
2X14P	13.0	17.00	14.90	1,000
2X15P	14.0	18.00	15.90	1,000
—	—	—	—	—
2X20P	19.0	23.00	20.90	1,000
—	—	—	—	—
2X25P	24.0	28.00	25.90	1,000
—	—	—	—	—
2X30P	29.0	33.00	30.90	1,000

组成序号	名称	材质
a	0.2 pin针	磷铜镀高温亮锡
b	接地片	磷铜镀高温亮锡
c	WAFER 主体	LCP(本色) UL94V-0
d	吸盖	LCP(本色) UL94V-0

GTER® 东莞市高嘉精密电子有限公司
DONGGUAN GJ PRECISION ELECTRONICS Co.,Ltd.

PART NO: GJ-A1004WVS-**-FON

1.00mm WIRE TO BOARD CONNECTOR, WAFER (V-SMT TYPE)

APPROVED BY: APPROVED	PROJ:
CHECKED BY: CHECKED	UNIT: mm
DRAWN BY: yiliangdong	SCALE: --
DATE: 2022-09-03	SHEET: 1/1 A4
A1004立式贴板针座产品图	VER NO: AO

TOLERANCE	LTR	REVISION RECORD	NAME	DATE
-1 ±0.10	标记1	修改内容1	姓名1	日期1
1-5 ±0.15	标记2	修改内容2	姓名2	日期2
5-15 ±0.20	标记3	修改内容3	姓名3	日期3
15-30 ±0.25	标记4	修改内容4	姓名4	日期4
30- ±0.30	CUSTOMER: ---			
(ANGLE) X ±10°	Conforms to The RoHS&REACH Instruction			

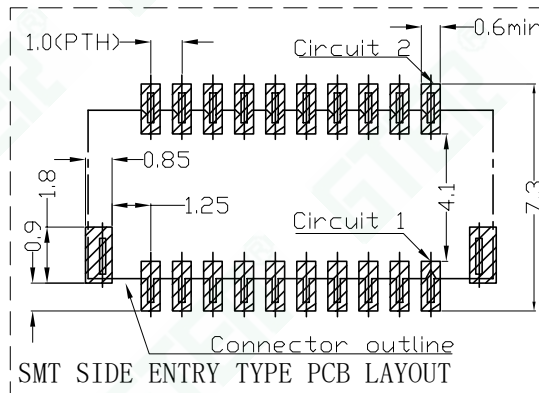
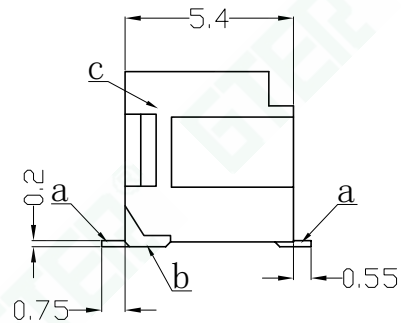
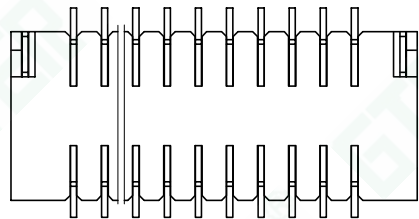
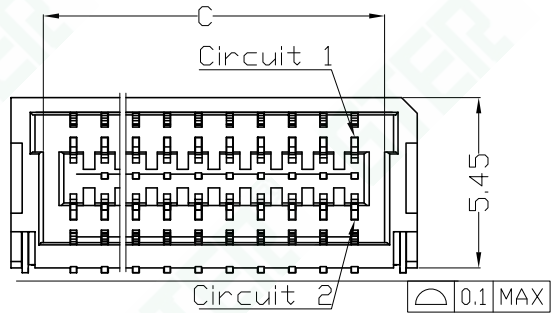
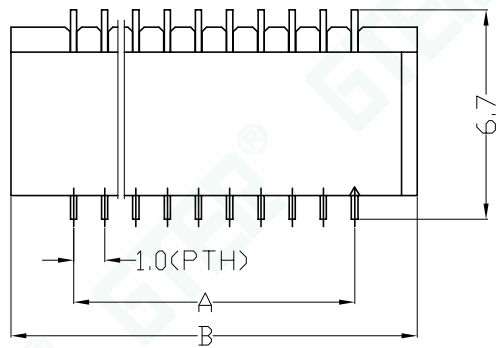

■ Main Specifications

- . 接触电阻 (Contact resistance): $\leq 20m\Omega$
- . 绝缘电阻 (Insulation resistance): $\geq 100M\Omega$
- . 额定电压 (Rated voltage): 50V AC DC
- . 额定电流 (Rated current): 1.0A AC DC
- . 耐电压 (Withstand Voltage): 500V AC/minute
- . 温度范围 (Temperature Range): $-25^{\circ}C \sim +105^{\circ}C$

■ 产品编码简介: GJ-A1004WRS-**-FON

1. 系列号; ① ② ③ ④
2. 卧式贴板针座;
3. Pin位数;
4. LCP UL94V-0 (本色)

■ 适配 GJ-A1004 SOCKET HOUSING SERIES.



Poles	Dimensions(mm)			Q'ty/ bag
	A	B	C	
2X2P	1.0	5.50	2.90	1,000
2X3P	2.0	6.50	3.90	1,000
2X4P	3.0	7.50	4.90	1,000
2X5P	4.0	8.50	5.90	1,000
2X6P	5.0	9.50	6.90	1,000
2X7P	6.0	10.50	7.90	1,000
2X8P	7.0	11.50	8.90	1,000
2X9P	8.0	12.50	9.90	1,000
2X10P	9.0	13.50	10.90	1,000
2X11P	10.0	14.50	11.90	1,000
2X12P	11.0	15.50	12.90	1,000
2X13P	12.0	16.50	13.90	1,000
2X14P	13.0	17.50	14.90	1,000
2X15P	14.0	18.50	15.90	1,000
—	—	—	—	—
2X20P	19.0	23.50	20.90	1,000
—	—	—	—	—
2X25P	24.0	28.50	25.90	1,000
—	—	—	—	—
2X30P	29.0	33.50	30.90	1,000

组成序号	名称	材质
a	0.2 pin针	磷铜镀高温亮锡
b	接地片	磷铜镀高温亮锡
C	WAFER 主体	LCP(本色) UL94V-0

GTER® 东莞市高嘉精密电子有限公司
DONGGUAN GJ PRECISION ELECTRONICS Co.,Ltd.

PART NO: GJ-A1004WRS-**-FON

1.00mm WIRE TO BOARD CONNECTOR, WAFER(V-SMT TYPE)

APPROVED BY: APPROVED

CHECKED BY: CHECKED

DRAWN BY: yiliangdong

DATE: 2022-09-03

A1004 卧式贴板针座产品图

PROJ:

UNIT: mm

SCALE: --

SHEET: 1/1 A4

VER NO: AO

TOLERANCE

-1 ±0.10

1-5 ±0.15

5-15 ±0.20

15-30 ±0.25

30- ±0.30

(ANGLE) X ±10°

LTR

标记1

标记2

标记3

标记4

CUSTOMER: ---

REVISION RECORD

修改内容1

修改内容2

修改内容3

修改内容4

NAME

姓名1

姓名2

姓名3

姓名4

DATE

日期1

日期2

日期3

日期4

Conforms to The RoHS&REACH Instruction